

# Quick Start

## Set the Brewer Up



1

Place the brewer on a flat surface.

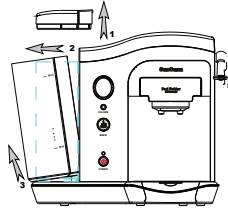

2

Remove the lid & water reservoir.

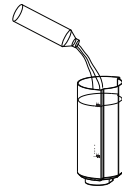

3

Rinse out the reservoir and fill up with filtered or purified water.

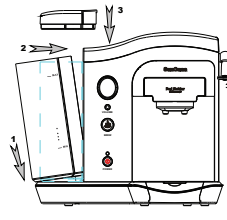

4

Place the reservoir and lid back onto the brewer.

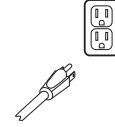

5

Plug the brewer in a grounded outlet. **DO NOT** press the 'power' button.

## Prime the Brewer (First Time Only)



6

Place a 14oz cup on the cup tray. Make sure the empty pod holder is in cavity & the handle is in lock position.

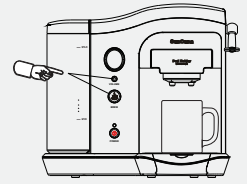

7

Press & hold down both 'volume' & 'brew' buttons for over 3 seconds.

## Brew Your First Cup of Coffee / Stop Brewing



8

Water will begin to flow through the unit and out the brew spout into cup. Press the 'power' button again to stop if your cup is not big enough.

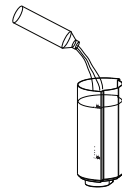

9

Refill the water reservoir with filtered or purified water.

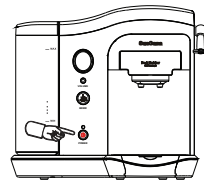

10

Press the 'power' button to turn on the brewer.

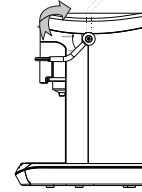

11

Lift the handle.

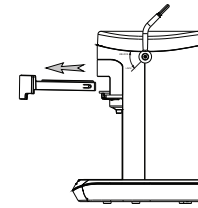

12

Pull out the pod holder.



13

Place a pod in the pod holder. (thicker side down)

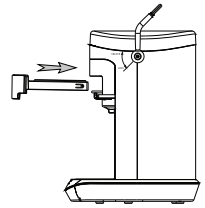

14

Gently slide the pod holder all the way into cavity.

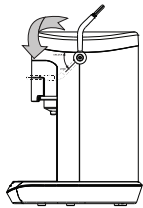

15

Lock the handle.



16

Press the 'volume' button to select from 5oz to 12oz.



17

Press the 'brew' button when the LED light turns green.

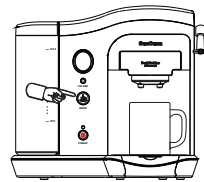

18

Press the 'brew' button again to stop brewing if it is preferred.

## My Cup Set Up - Calibration

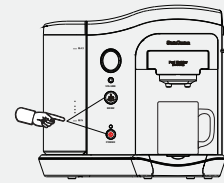

Make sure the brewer is at 'Standby mode', (See Manual Page 9 for details)

## Temperature Set Up

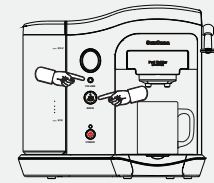

Make sure the brewer is at 'Standby mode', (go to [www.singleservebrewer.com](http://www.singleservebrewer.com) for details)